

FUNDATIE TIP FT16 / FOUNDATION TYPE FT16

Vedere de sus A-A / Top view A-A
Scara 1:20 / Scale 1:20

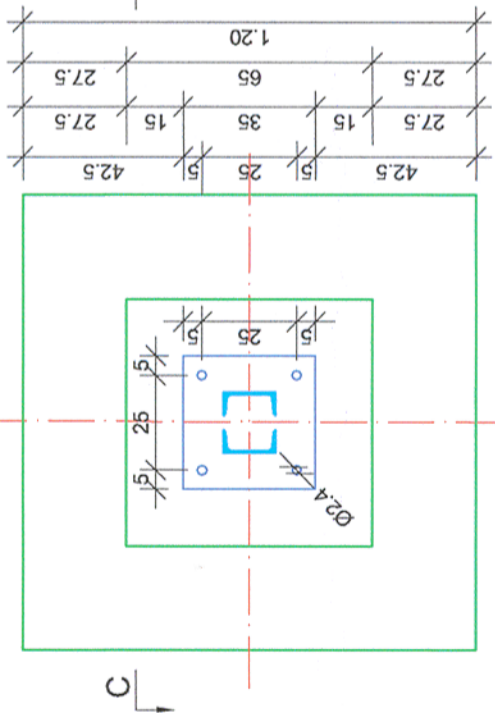

Vedere de sus B-B / Top view B-B
Scara 1:20 / Scale 1:20

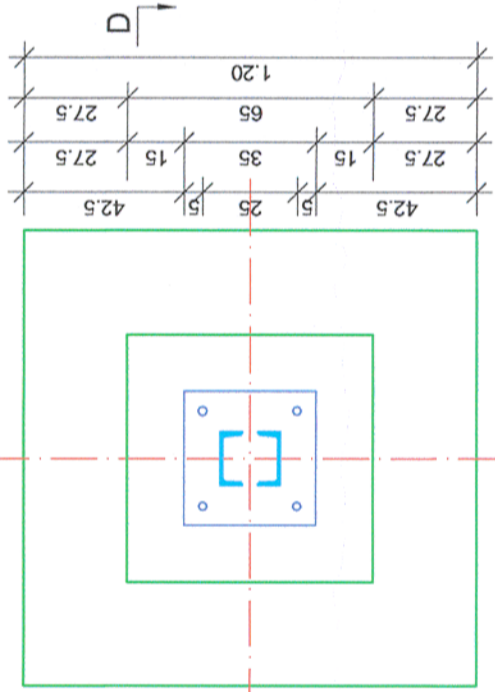

Sectiune transversala C-C / Cross section C-C
Scara 1:20 / Scale 1:20

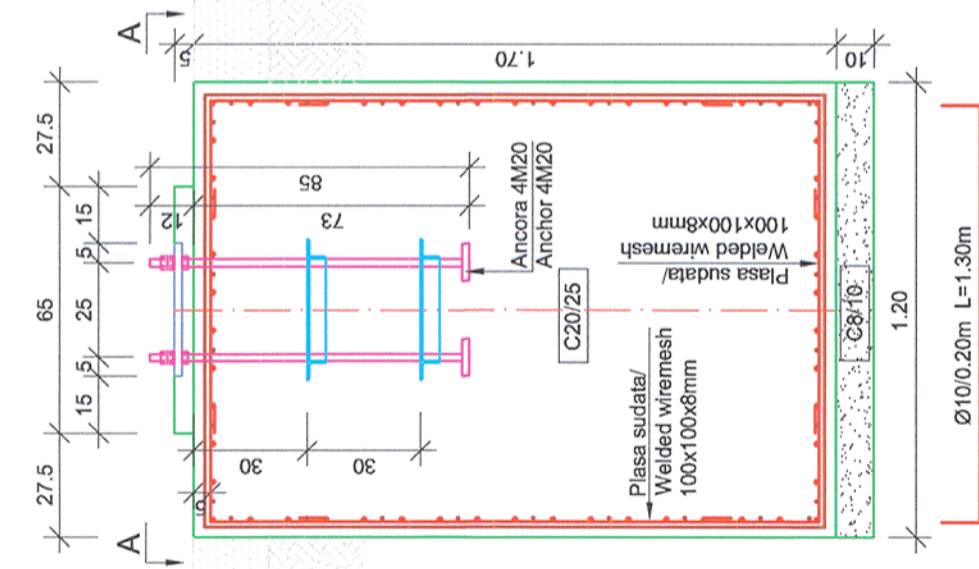

Sectiune transversala D-D / Cross section D-D
Scara 1:20 / Scale 1:20

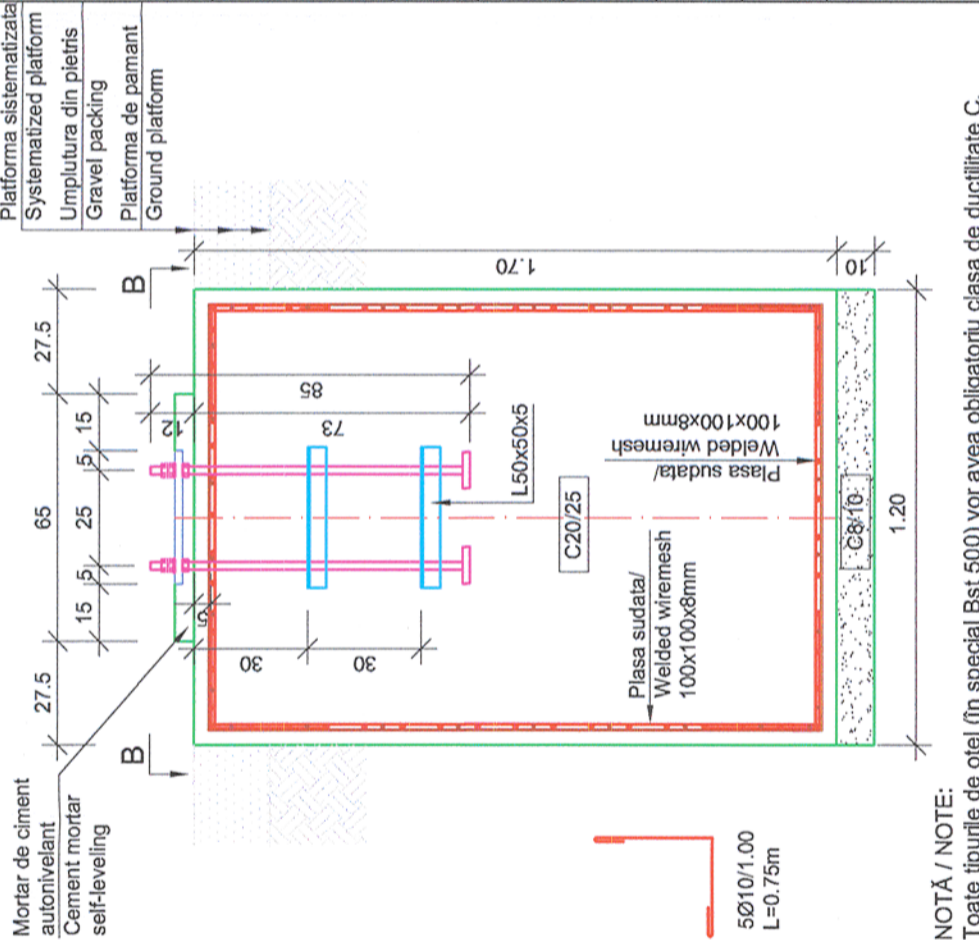

NOTĂ / NOTE:
Toate tipurile de oțel (în special Bst 500) vor avea obligatoriu clasa de ductilitate C.
All types of steel (especially Bst 500) will mandatory have the ductility class C.

CLASA DE IMPORTANTA A CONSTRUCȚIEI
CONFORM P100/1-2006 ESTE (III)
CATEGORIA DE IMPORTANTA
CONFORM HG nr. 766/97 este (C)

MATERIALE:

Beton simplu C8/10;
Beton armat C20/25 CEM III/A-S 42.5 N ; sort 0-31; A/C : 0.55 ;
Oțel Beton Bst 500 ;
Clasa de expunere: XC2

THE CONSTRUCTION IMPORTANCE CLASS,
ACCORDING TO P 100/1-2006, IS (III)
THE IMPORTANCE CATEGORY,
ACCORDING TO HG 766/97 IS "C"

MATERIALS:

Concrete C8/10 ;
Reinforced concrete C20/25 CEM III/A-S 42.5 N ; sort 0-31 A/C : 0.55 ;
Reinforcement Bst 500 ;
Exposure class: XC2

Proiectul de structura se va corela cu proiectul celorlalte specialitati (parte scrisa si parte desenata).
The structural project (blueprints, technical briefs, technical specifications) will be correlated with the other specialitis projects (blueprints, technical briefs, technical specifications).

Acest plan anuleaza si inlocuieste planul nr. PT.02.04.12.RE.09.009 elaborat la data 01.2013.

This layout plan canceled and replaced layout plan no. PT.02.04.12.RE.09.009 prepared on 01.2013.

European Investment Bank		MINISTERUL TRANSPORTURILOR		BENEFICIAR / BENEFICIARY :		COMPANIA NAȚIONALĂ DE CĂI FERATE "CFR" SA	
Verificator / Expert Checker / Expert		Cerința / Requirement Requirement		Semnătura / Signature Signature		Referat / Expertiză Report / Expertise	
PROIECTANT / DESIGNER:				PÖYRY			
Aprobat / Approved		Șef de echipă / Team leader		C. Teodorescu		Data / Date 01.2013	
Verificat / Checked		Expert Cheie / Key Expert		R. Witan		Semnătura / Signature <i>R. Witan</i>	
Subcontractant / Subcontractor							
Aprobat / Approved		Adjunct Șef de echipă / Deputy Team leader		A.M. Baicu		Data / Date 01.2013	
Proiectat / Designed		Inginer / Engineer		G. Staicu		Semnătura / Signature <i>G. Staicu</i>	
"Reabilitarea liniei c.f. Frontieră - Curtici - Simeria, parte componentă a coridorului IV Pan - European pentru circulația trenurilor cu viteză maximă de 160 km/h" Tronsonul 2 - B: Cap Y Bărzava - Cap Y Ilteu "Rehabilitation of the Railway Line Border - Curtici - Simeria, component Part of the IV Pan - European Corridor for the Trains Circulation with maximum speed of 160 km/h" Section 2 - B: End Y Bărzava - End Y Ilteu							
Denumire desen / Drawing name: Fundație tip FT16 - Substație de tracțiune - Stația V ărația / Foundation type FT16 - Traction substations - V ărația Station							
Scara / Scale 1:20		Revizia / Revision 1/05.2013		Cod desen / Drawing Code PT.2B.04.12.RE.09.009		Nr / No 09/12	

Project 9i
35311.1
Faza / Phase:
PTh+CS / TD+TS